

INSTRUCTION

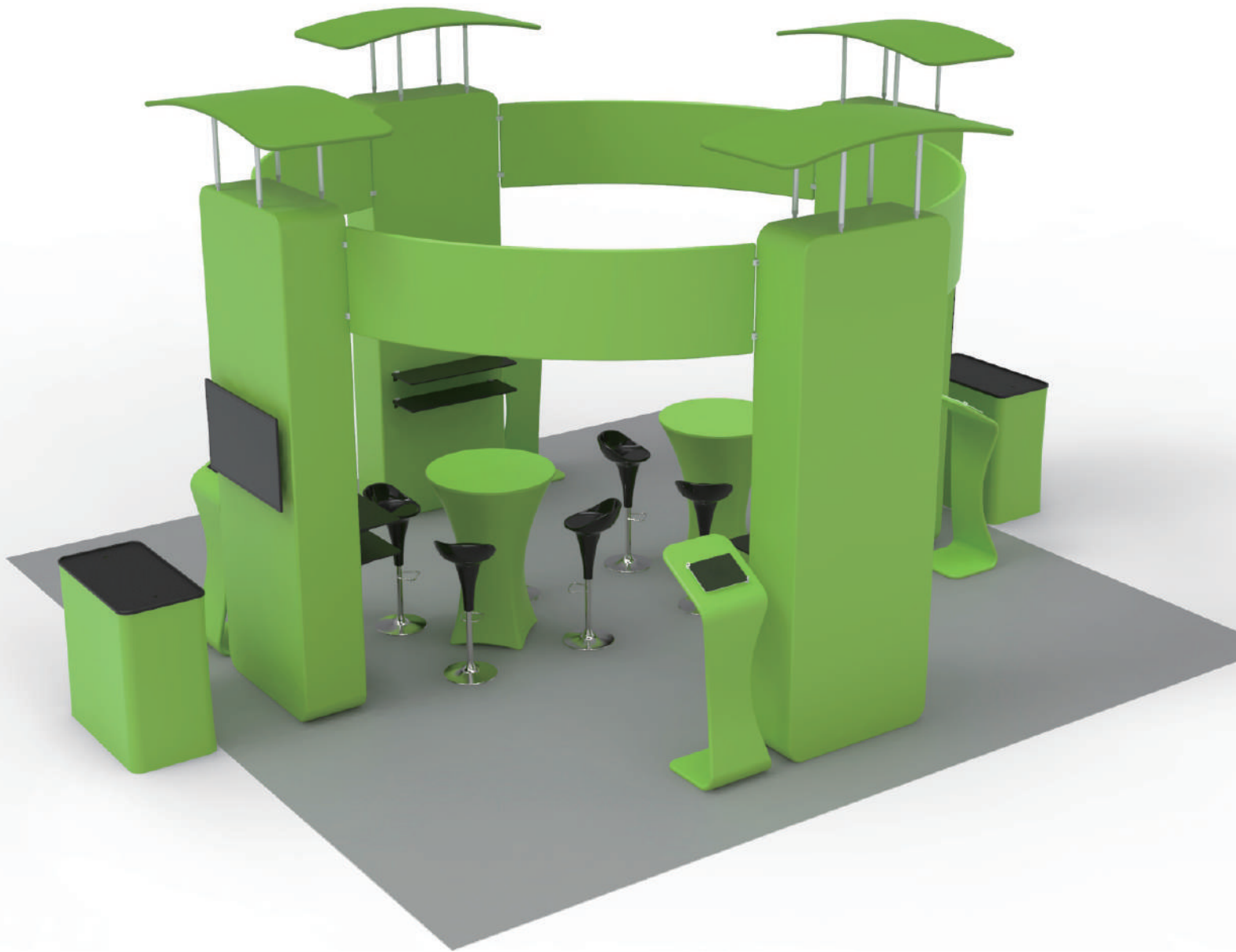

20X20FT-BOOTH-A

STEPS

(1) Hardware

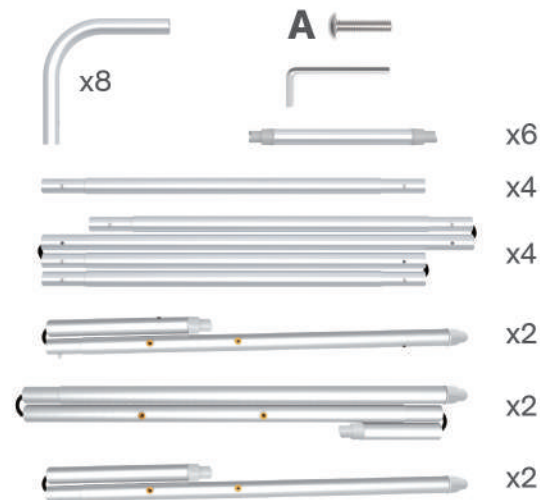

(2) Printed Graphic Fabric Banner (Optional)



STEP 01

To connect the poles according to the labellings

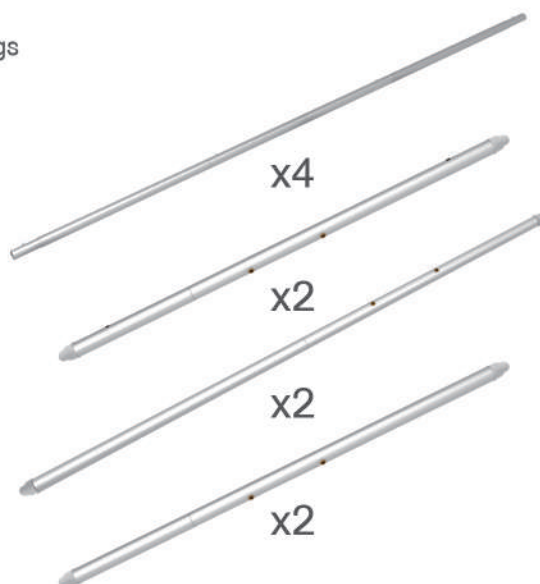
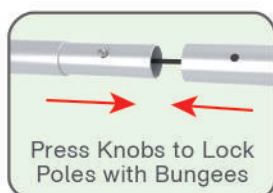
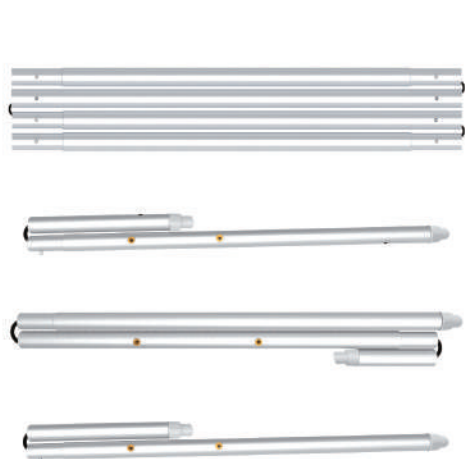

STEP 02

Connect long poles with corner poles according to labelings.

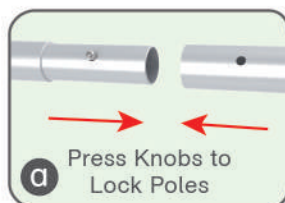
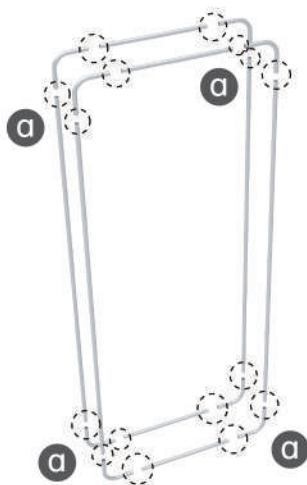

STEPS

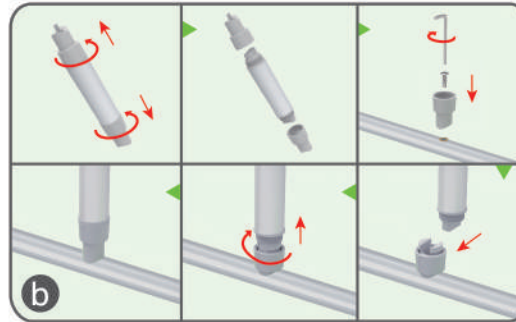
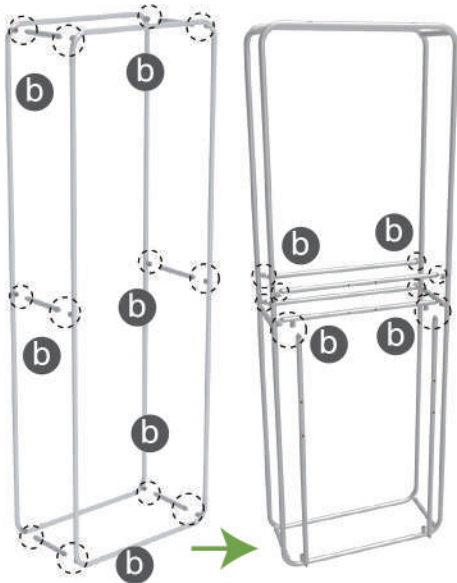
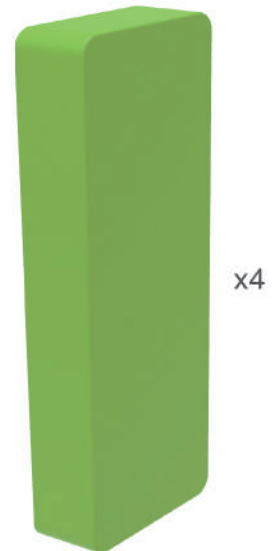
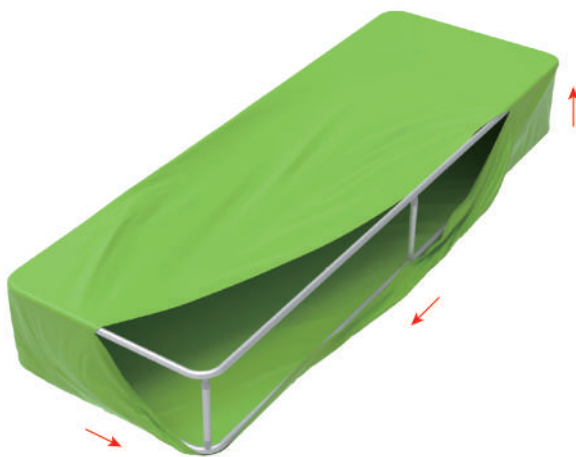
STEP 03 Connect support poles onto column frame.**STEP 04** Slide fabric banner on frame from top and zip up at bottom.

(1) Hardware

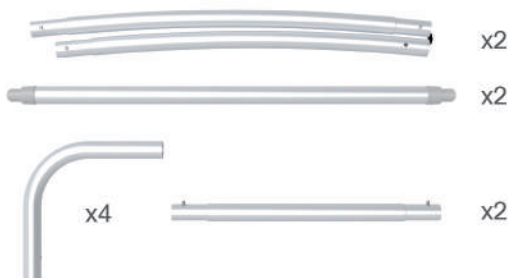

(2) Printed Graphic Fabric Banner (Optional)

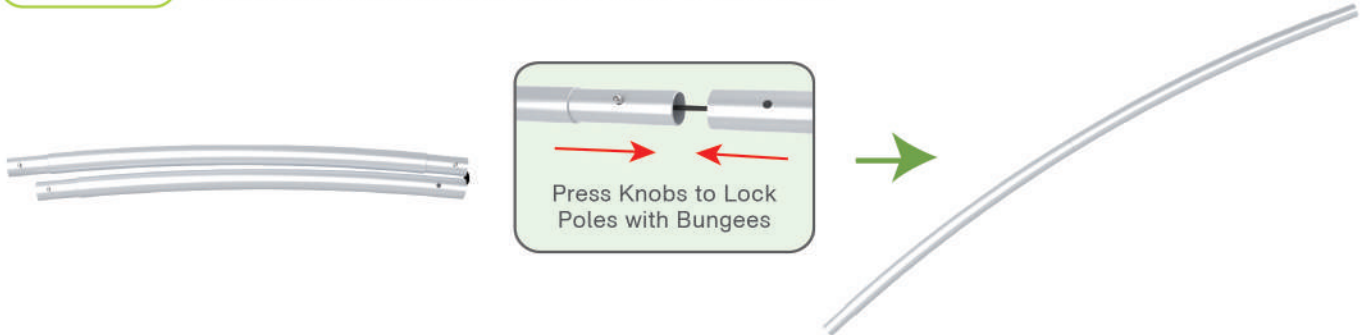
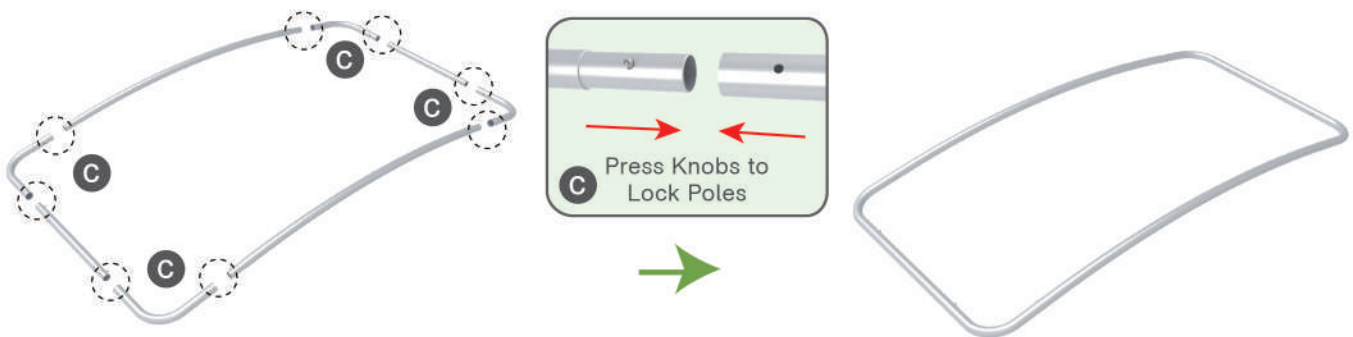
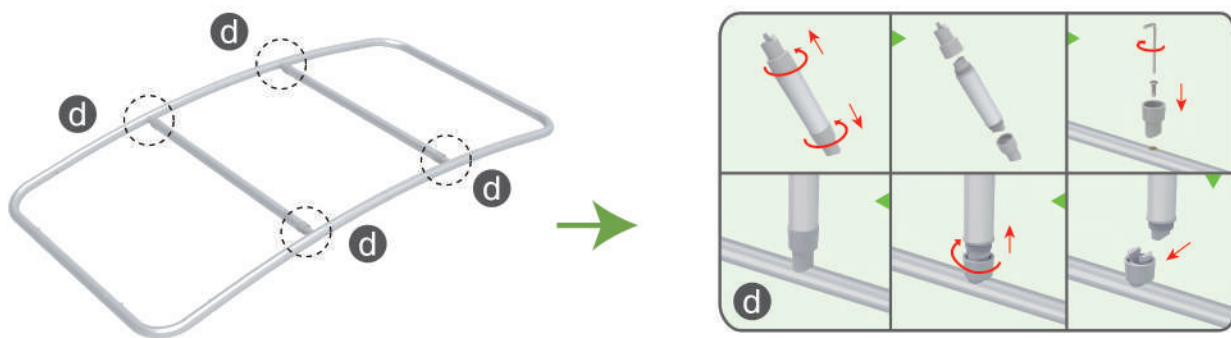

STEPS

STEP 01 Connect to make long poles according to labelings.**STEP 02** Connect long poles with corner poles according to labelings.**STEP 03** Connect support poles onto frame.**STEP 04** Slide fabric banner on frame from left and zip up at right.

Same Steps for Other Display Stands

STEPS

Booth Set Assembly

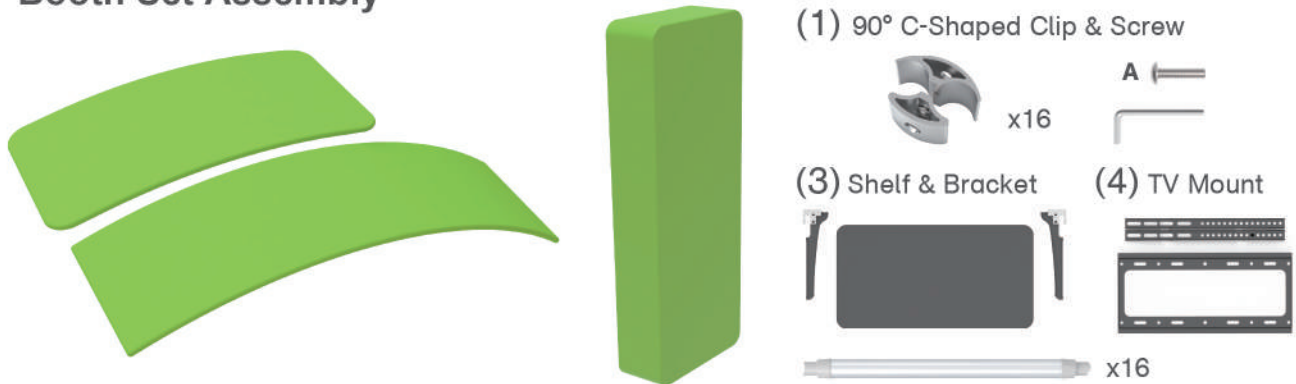

STEP 01 Connect support poles onto column frame and canopy.

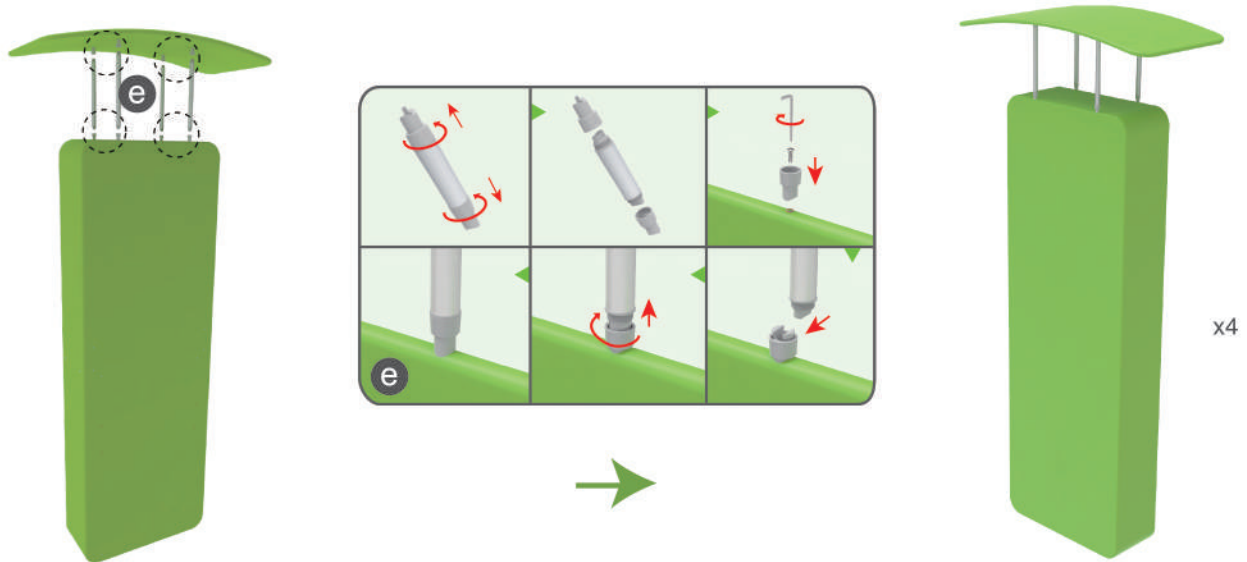

STEP 02 Interconnect display stands with C-shaped clips.

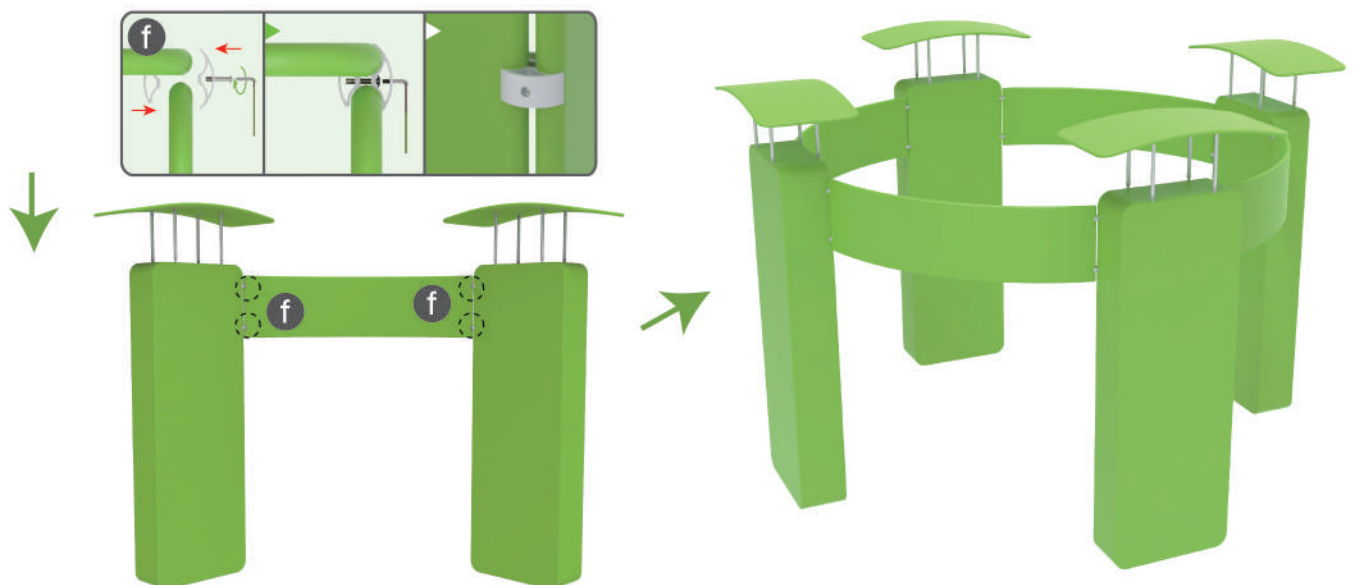

STEPS

STEP 03

Screw brackets onto display stand with hex wrench, insert shelves into slots.

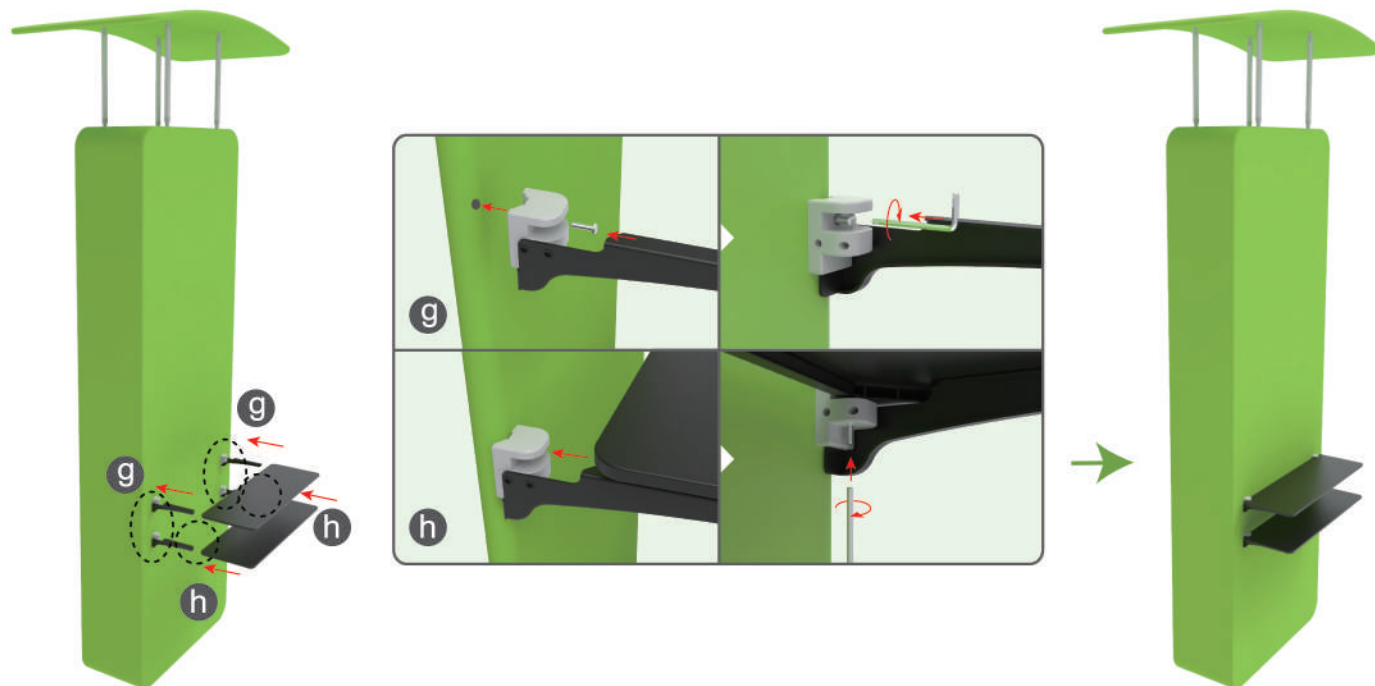

STEP 04

Screw TV mount onto display stand & support brackets onto TV's back with hex wrench, hang TV onto mount & screw.

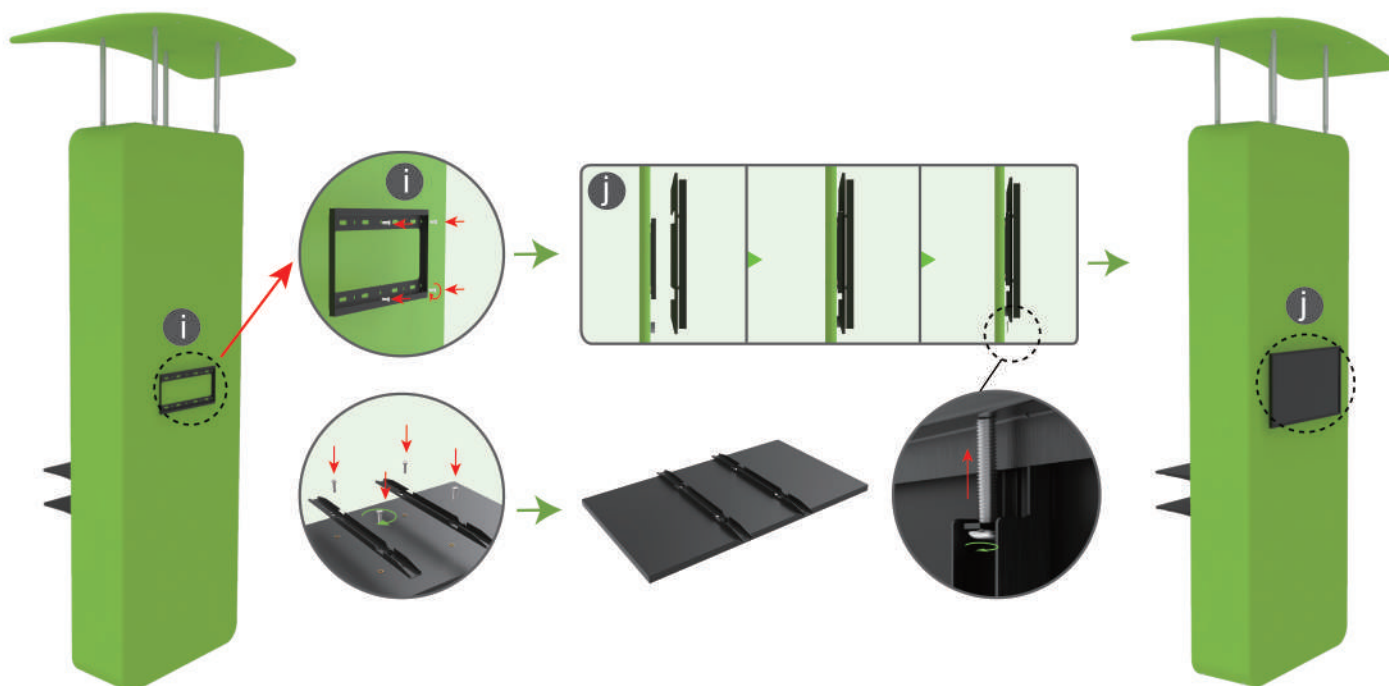

STEPS

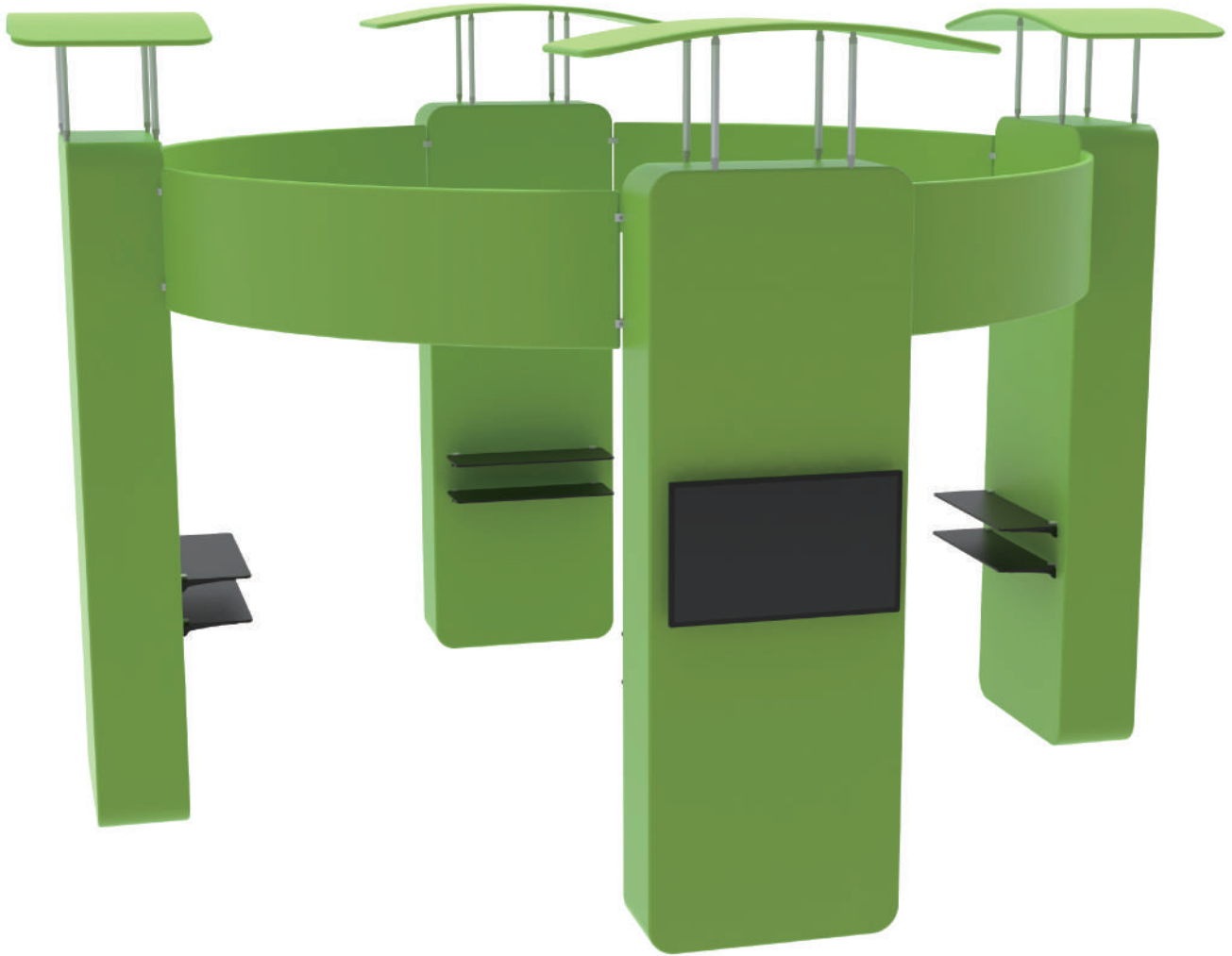

20X20FT-BOOTH-A

STEPS

(1) Hardware



(2) Countertop Panel

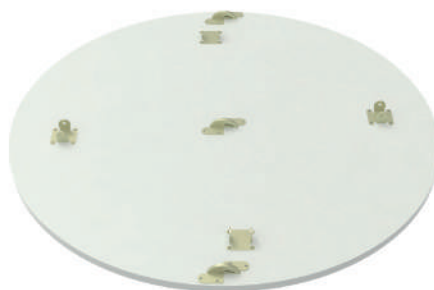

(3) Fixing Accessory



(4) Printed Graphic Fabric Banner



STEP 01

Connect to make long poles according to labelings.

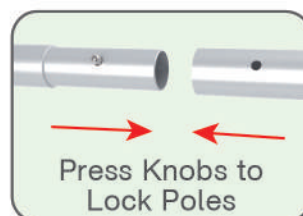

STEP 02

Insert poles into fixing accessory until you hear a 'Ding' sound to make poles' knobs clip into it & its concave parts pop out.



STEPS

STEP 03 Press poles' knobs to clip into countertop's slot.

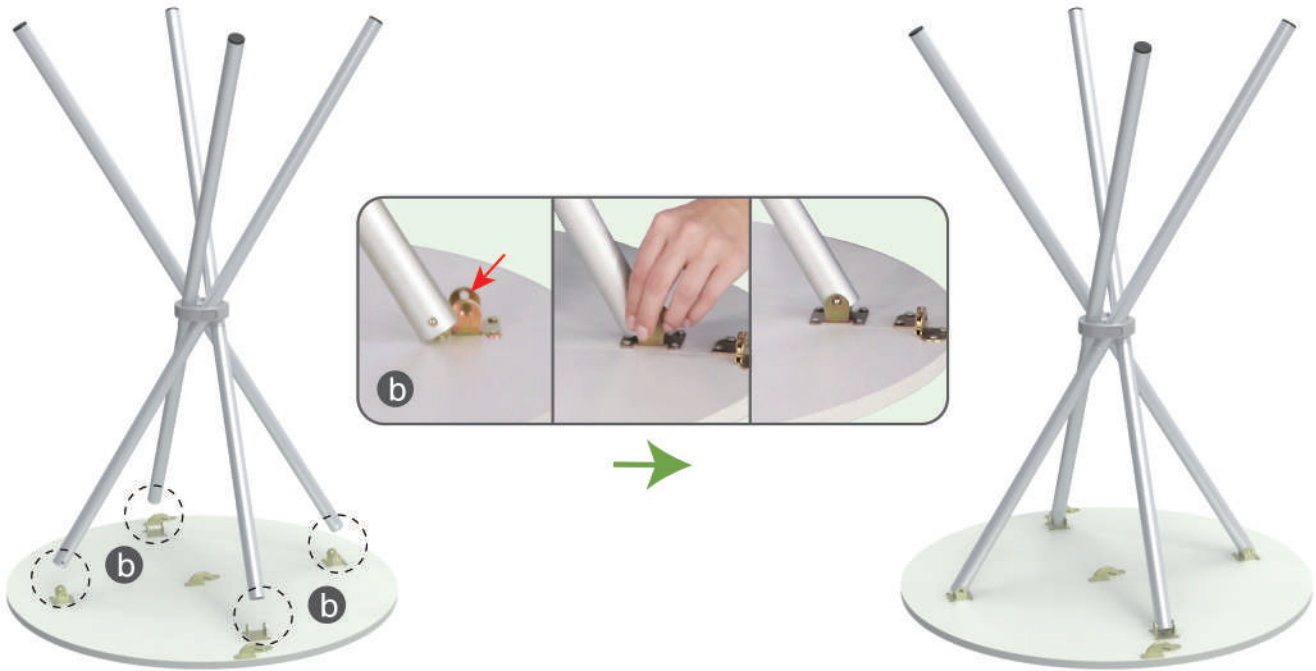
**STEP 04**

Wrap fabric banner from top to bottom, put poles into pockets & zip up.

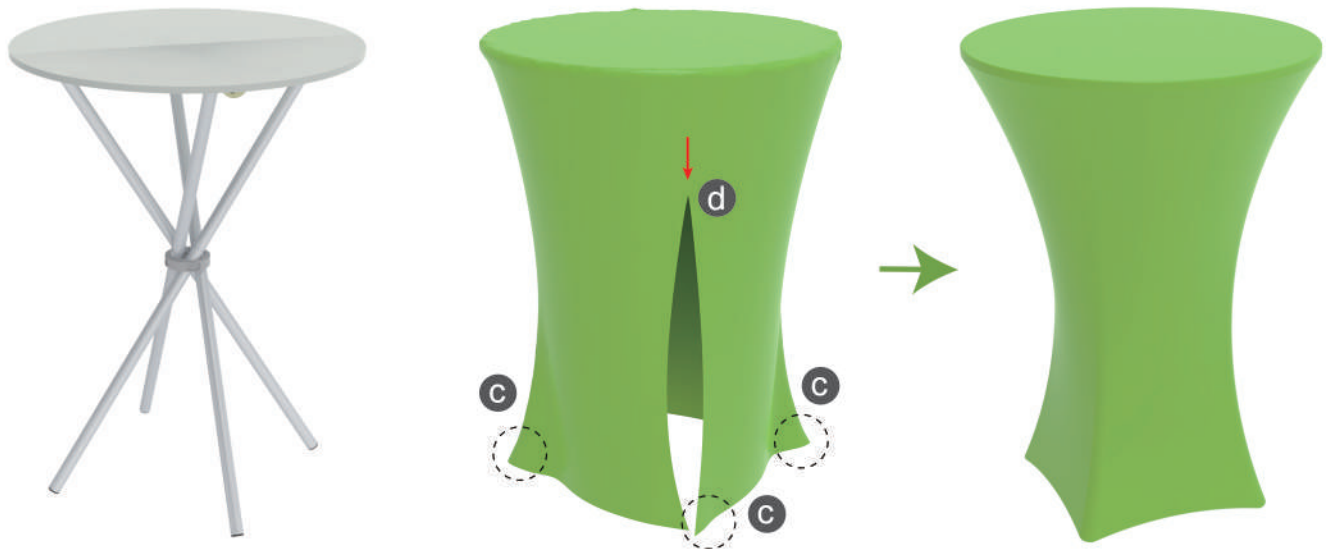
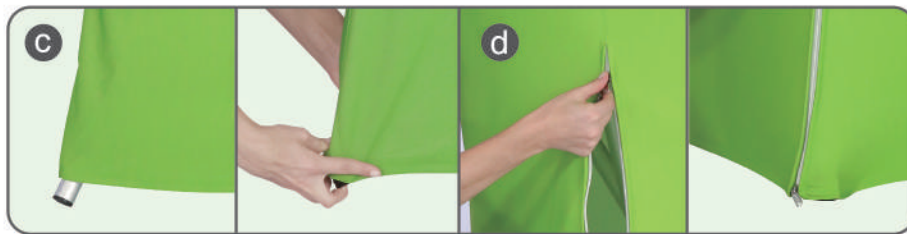

STEPS

(1) Durable Plastic Hard Case, Aluminum Support Poles



(2) Printed Graphic Fabric Banner



STEP 01

Put hard case's top into fabric banner.

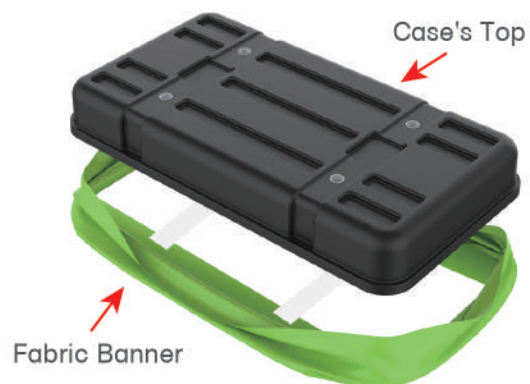

STEP 02

Insert support poles into hard case's top & bottom.

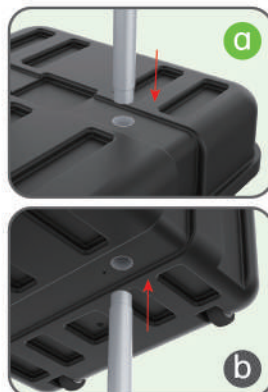

STEPS

STEP 04

Wrap fabric banner from bottom to top & twist it to be smooth, lay hard case's intermediate panel on podium's top.

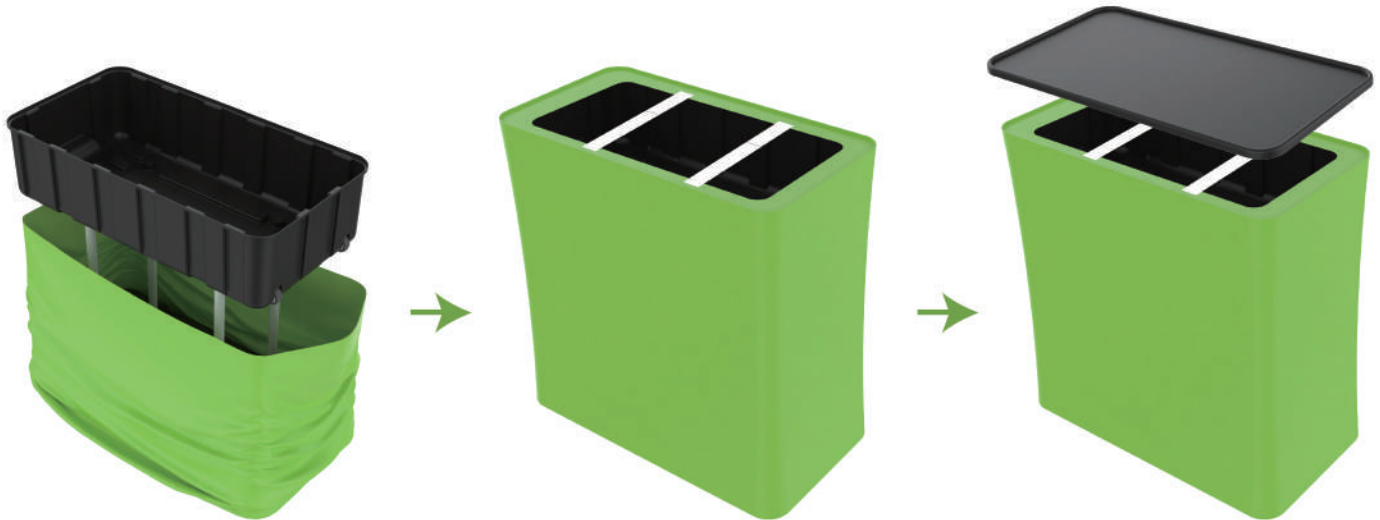

★ One Tool (Hex Wrench) **STEPS**

(1) Snap Tubes

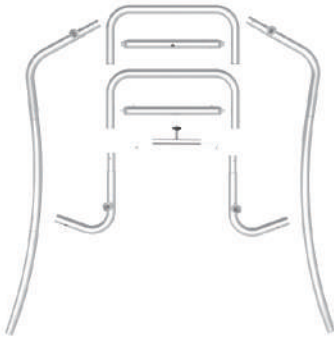

(2) Printed fabric banner



(3) Tablet PC holder

**STEP 01**

To Connect the tubes according to the labellings

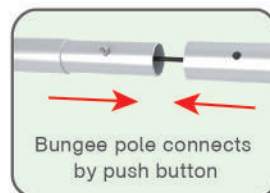
**STEP 02**

To connect 2 long side tubes by the corner pieces

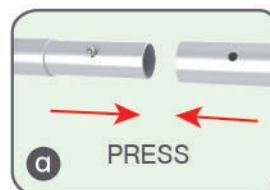

STEPS

STEP 03

To install the cross bar according to labellings

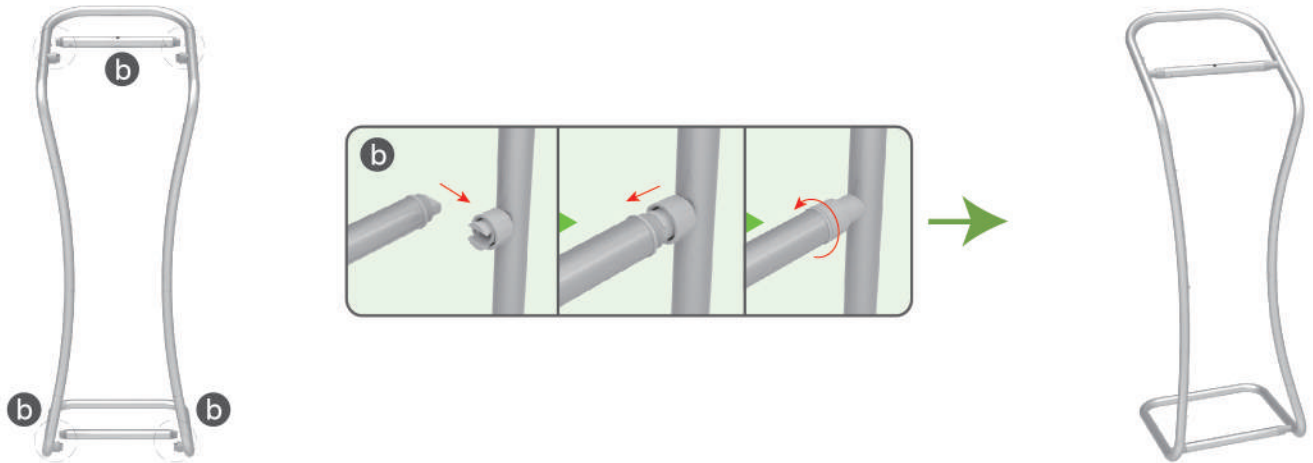

STEP 04

To wrap the fabric cover from top to bottom and zip to the middle of frame, then put the iPad in the holder and adjust the holder to right size and lock it by Allen Key Afterwards, install the set to the display stand.

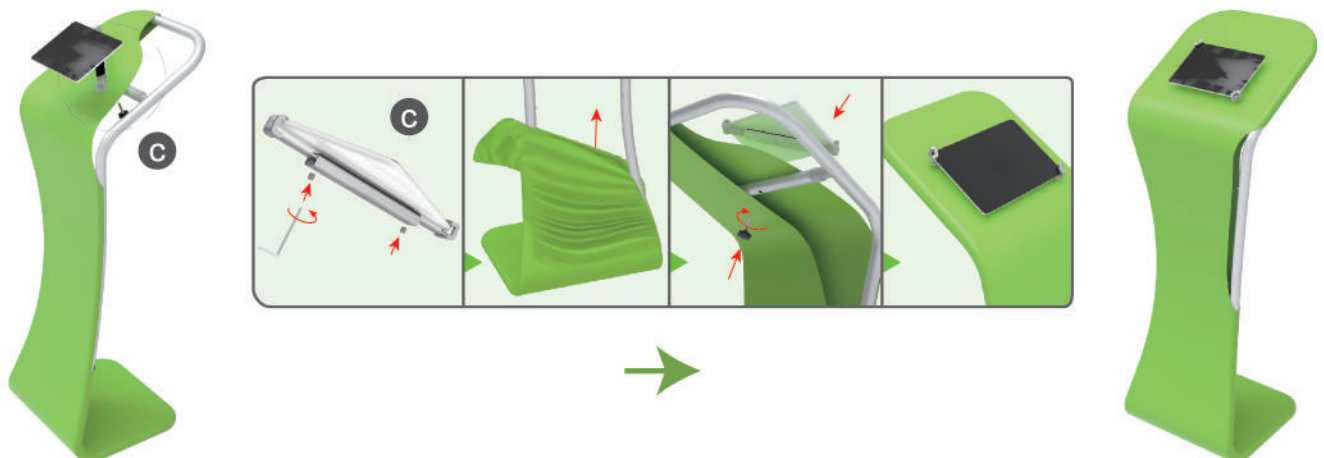

STEP 05

Zip up completely

